



Forest Dental Component Catalogue

LIGHT SERVICE
ITEMS **1**

HANDPIECE
CONTROLS **2**

ARM
SYSTEMS **3**

SYRINGES **4**

FOOT
CONTROLS **5**

VACUUM **6**

HOLDERS **7**

VALVES **8**

ACCESSORIES **9**

FITTINGS **10**

TUBING **11**

SERVICE
ITEMS **12**

PARTS
BREAKDOWN **13**

Phantom Head Dental

950 Manchester Road
Linthwaite, Huddersfield, HD7 5QS

Tel/Ans: 01484 843 100
Fax: 01484 843 888

Email: sales@phantomhead.com
Website: www.phantomhead.com



Syringes

4 FORESTAR-3 STANDARD SYRINGE ASSEMBLY

Provides variable control for air, water and spray.

INCLUDES

- Universal autoclavable quick disconnect tip
- Tubing
- Service tool

DESCRIPTION

WITH FLOW ADJUSTMENT BLOCK
WITHOUT FLOW ADJUSTMENT BLOCK



WITH BLOCK	WITHOUT BLOCK	
	1107-086	SYRINGE ONLY w/o TUBING
1107-218	1107-238	STRAIGHT STERLING TUBING
1107-186	1107-196	SHEATHED STERLING TUBING
1107-208	1107-228	COILED STERLING TUBING
1107-217	1107-237	STRAIGHT GRAY TUBING
1107-185	1107-195	SHEATHED GRAY TUBING
1107-207	1107-227	COILED GRAY TUBING
1107-213	1107-233	STRAIGHT BLACK TUBING
1107-286	1107-288	SHEATHED BLACK TUBING
1107-203	1107-223	COILED BLACK TUBING
1107-918	1107-938	STRAIGHT SHADOW TUBING
1107-986	1107-996	SHEATHED SHADOW TUBING
1107-908	1107-928	COILED SHADOW TUBING

FORESTAR-3 STRAIGHT SYRINGE ASSEMBLY

Provides fingertip control for air, water and spray.

INCLUDES

- Universal autoclavable quick disconnect tip
- Tubing
- Service tool

DESCRIPTION

WITH FLOW ADJUSTMENT BLOCK
WITHOUT FLOW ADJUSTMENT BLOCK



WITH BLOCK	WITHOUT BLOCK	
	1107-096	SYRINGE ONLY w/o TUBING
1107-246	1107-296	SHEATHED STERLING TUBING
1107-245	1107-295	SHEATHED GRAY TUBING
1107-243	1107-244	SHEATHED BLACK TUBING
1107-946	1107-995	SHEATHED SHADOW TUBING



Syringes

4 FORESTAR-3 STANDARD HEATED SYRINGE



The Forestar-3 Standard Heated Syringe provides instant warm water at the syringe tip during normal operations. A heated element within the syringe tubing tempers the water as it advances through the system.

INCLUDES

- Standard syringe with universal autoclavable QD tip
- Power source with high/low and on/off controls
- Tubing
- Low voltage wire, 10'

DESCRIPTION

110VAC
220VAC



MANUAL ON/OFF

AIR-ACTUATED ON/OFF

1107-118	1107-418	SHEATHED STERLING
1107-108	1107-408	COILED STERLING
1107-117	1107-417	SHEATHED GRAY
1107-107	1107-407	COILED GRAY
1107-113	1107-413	SHEATHED BLACK
1107-103	1107-403	COILED BLACK
1107-917	1107-916	SHEATHED SHADOW
1107-907	1107-906	COILED SHADOW

Note: 220VAC is only offered in a Euro style plug.
1/2 Amp Fuse - Volts 10.5 Low 12 High w/ Load

FORESTAR-3 STRAIGHT HEATED SYRINGE



The Forestar-3 Straight Heated Syringe provides instant warm water at the syringe tip during normal operations. A heated element within the syringe tubing tempers the water as it advances through the system.

INCLUDES

- Straight syringe with universal autoclavable QD tip
- Power source with high/low and on/off controls
- Tubing
- Low voltage wire, 10'

DESCRIPTION

110VAC
220VAC



MANUAL ON/OFF

AIR-ACTUATED ON/OFF

1107-168	1107-468	SHEATHED STERLING
1107-167	1107-467	SHEATHED GRAY
1107-163	1107-463	SHEATHED BLACK
1107-968	1107-969	SHEATHED SHADOW

Note: 220VAC is only offered in a Euro style plug.
1/2 Amp Fuse - Volts 10.5 Low 12 High w/Load



Syringes

4

HEATED SYRINGE CONVERSION KIT



The Heated Syringe Conversion Kit adapts to existing 3-way syringes to provide instant warm water during normal operations.

INCLUDES

- Power source with variable temperature and on/off controls(1/2 Amp fuse, Volts 10 1/2 - 12 w/ load applied)
- Size, 2-3/4" x 5" x 2-1/2"
- Tubing
- Low voltage wire, 10'



DESCRIPTION

110VAC
220VAC

MANUAL ON/OFF

AIR-ACTUATED ON/OFF

1107-148	1107-448	SHEATHED STERLING
1107-144	1107-444	COILED STERLING
1107-147	1107-447	SHEATHED GRAY
1107-137	1107-437	COILED GRAY
1107-143	1107-443	SHEATHED BLACK
1107-133	1107-433	COILED BLACK
1107-948	1107-942	SHEATHED SHADOW
1107-941	1107-947	COILED SHADOW
0014-001	0014-004	POWER SOURCE ONLY

Note: 220VAC is only offered in a Euro style plug.

Note: Replacement tubing see pg. 70

WATER HEATER



Compact 4 oz. reservoir type water heater with manual or air-actuated on/off control. Temperature pre-set at 105° for comfort and quick recovery. May be mounted upright or in prone position. Noncorrosive nickel plated. Not recommended with clean water systems.

INCLUDES

- Reservoir-type heater, 200 watt, 1.67 amp
- 10-32 x 1/16" barbs with sleeves

DESCRIPTION

AIR-ACTUATED ON/OFF, 110VAC
AIR-ACTUATED ON/OFF, 220VAC

PART NO.

0014-095
0014-106



Syringes

4

SYRINGE TIP KIT, UNIVERSAL



For all Forestar-3 syringes

INCLUDES

- One autoclavable syringe tip, nut, adapter and service tool
- Brown Viton o-ring

DESCRIPTION
SYRINGE TIP KIT

PART NO.
1107-695

LOCKING SYRINGE TIP KIT, FOREST



Locking Syringe Tip for Forestar-3 syringe.

INCLUDES

- Nut, cone, o-rings, adapter and allen wrench

DESCRIPTION
LOCKING SYRINGE TIP KIT
O-RING KIT

PART NO.
1107-062
0015-096

AUTOCLAVABLE SYRINGE TIP (325°F), FOREST



Syringe tip for Forestar-3 syringe.
(Prior to 1998)

DESCRIPTION
SYRINGE TIP ONLY
PKG. OF 5 SYRINGE TIPS

PART NO.
1107-020
1107-063

AUTOCLAVABLE SYRINGE TIP (325°F), UNIVERSAL



Syringe tip for Forestar-3 & Asepsis -3 syringe.
(After 1998)

DESCRIPTION
SYRINGE TIP ONLY
PKG. OF 5 SYRINGE TIPS

PART NO.
1107-690
1107-691

SYRINGE REPLACEMENT CARTRIDGE



Fits Forestar-3 syringe.

DESCRIPTION
NON-AUTOCLAVABLE BLACK O-RINGS
AUTOCLAVABLE, BROWN O-RINGS

PART NO.
1107-070
1107-330

SYRINGE CARTRIDGE KIT



For Forestar-3 syringe.

DESCRIPTION
NON-AUTOCLAVABLE BLACK O-RINGS
AUTOCLAVABLE, BROWN O-RINGS

PART NO.
1107-770
1107-333



Syringes

4

SYRINGE BUTTON ASSEMBLY



Syringe button assembly for Asepsis-3, DCI and Parts Warehouse syringe.

DESCRIPTION
SPOOL VALVE

PART NO.
1107-721

SYRINGE SERVICE TOOL



Used for removal of cartridge, tip adapter and barbs. For Forestar-3 syringe.

DESCRIPTION
SYRINGE SERVICE TOOL

PART NO.
1107-057

FLOW ADJUSTMENT BLOCK



Provides air/water metering to syringe.

INCLUDES
• 1/16" & 1/8" barbs, washes and sleeves

DESCRIPTION
FLOW ADJUSTMENT BLOCK

PART NO.
0016-092

SYRINGE O-RING KIT, FOREST



Includes all o-rings and service tool. For Forestar-3 syringe.

DESCRIPTION
NON-AUTOCCLAVABLE
AUTOCCLAVABLE

PART NO.
0015-099
0015-089

SYRINGE O-RING KIT, UNIVERSAL



Includes all o-rings and service tool. For Forestar-3 syringe.

DESCRIPTION
NON-AUTOCCLAVABLE
AUTOCCLAVABLE

PART NO.
0015-098
0015-088

ASEPSIS-3 SYRINGE REPAIR KIT

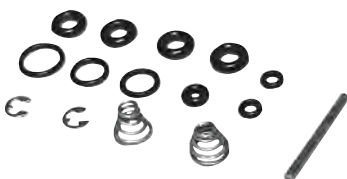

Syringe repair kit for Asepsis-3, DCI, and Parts Warehouse syringe.

DESCRIPTION
SPOOL VALVE

PART NO.
1107-694

Phantom Head Dental

950 Manchester Road
Linthwaite, Huddersfield, HD7 5QS

Tel/Ans: 01484 843 100
Fax: 01484 843 888

Email: sales@phantomhead.com
Website: www.phantomhead.com

